

# 3-D Jamestown Map

Students make a model of Jamestown,  
the first permanent English settlement  
in America.

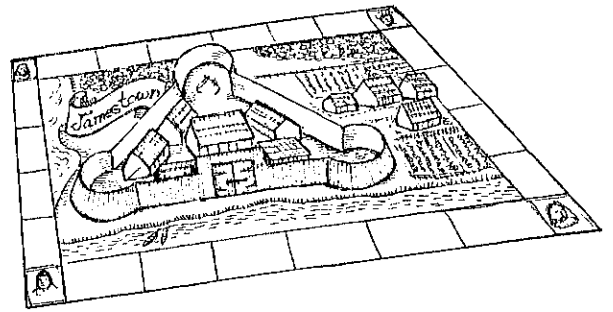

## Colonial Bays and Ways

In 1606 King James I gave permission to the Virginia Company of London to found a settlement in the Chesapeake region of Virginia. That December three ships—the *Susan Constant*, the *Godspeed*, and the *Discovery*—sailed from England with 105 men and boys and 39 sailors. They were to settle Virginia and find gold and a water route to Asia. In May 1607 the ships reached Virginia and sailed up the James River. The men founded Jamestown, which was named after the king, and they proceeded to build the triangular-shaped Fort James. Wooden walls protected houses, the church, and the storehouse inside the fort.

Within a few months more than half the men had died from malaria, starvation, or attacks by Native Americans. In 1608 additional settlers arrived with chickens, pigs, and goats. Under Captain John Smith's strict leadership, everyone had to work hard to keep the settlement from failing. But Jamestown was saved by Chief Powhatan and his confederacy of tribes who traded food for English goods. They also taught the settlers how to plant corn and other Indian crops and how to hunt game in the woods. After Captain Smith returned to England because of an injury, some colonists cut down on the amount of work they did. As a result, so many died during the winter of 1609–1610 that it was called the "starving time." When the new governor, Baron De La Warr, arrived from England with supplies, he made the colonists plant crops and dig wells.

The settlement grew as bigger houses were built outside the fort walls. In 1612 a Jamestown settler named John Rolfe found a new way to grow tobacco. Tobacco was shipped to England, where it became popular. Soon more and more colonists arrived to make money from growing tobacco. John Rolfe married Powhatan's daughter, Pocahontas. According to legend, Pocahontas once saved John Smith's life.

In 1619 the colonists set up the House of Burgesses, the first elected representative body in the New World. In 1624 the king made Jamestown a royal colony under his control.

No one knows what happened to Fort James. After about 1625 there is no mention of it in any writings. Some people think the fort was destroyed. Others believe it was buried under mud during a flood and archaeologists are searching for it.

**MATERIALS**

- ✦ copies of reproducible pages 19–21 for each group (Enlarge them if possible.)
- ✦ crayons, colored pencils, or markers
- ✦ scissors
- ✦ tape
- ✦ 10- by 14 1/2-inch piece of cardboard for each group (optional)

**Map It!**

Have students find the colony of Virginia on page 19. (Point out that this shows the shape of Virginia during the Colonial era.) Then challenge them to find it on the Thirteen Colonies map (pages 8–9). Students can then label and color it in on the map.

## Making the Model

To make this model, consider dividing the class into groups of three or four and letting each group make one. Then guide students in following these directions to make the model:

1 Color the pages, as desired.

2 Cut out the map on pages 20 and 21. Tape the edge of page 20 to the edge of page 21, where indicated. Then tape the map to a piece of cardboard for added durability.

3 Cut out the three FORT WALL patterns on page 19. Tape them together as follows:

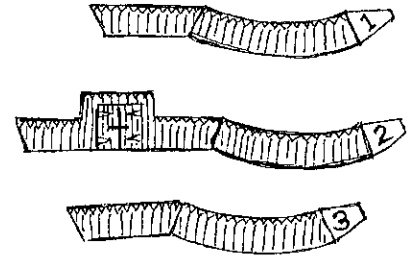

✦ Tape the tab on pattern 1 to the end of pattern 2. (Make sure the pointed ends of the fence face in the same direction and that the slanted edges match up.)

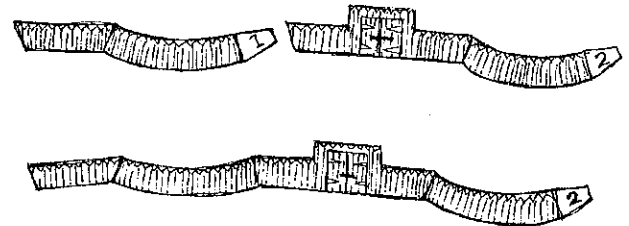

✦ Then tape the tab on pattern 2 to the end of pattern 3.

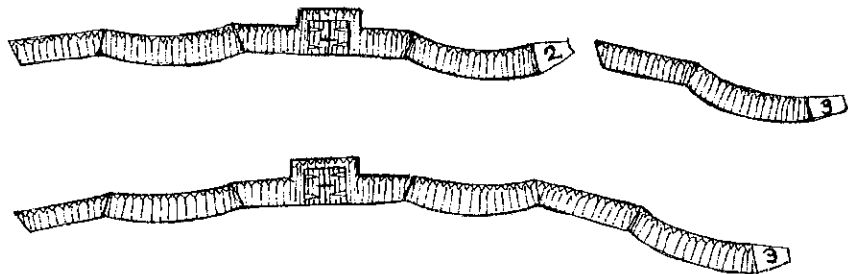

✦ Finally, tape the tab on pattern 3 to the end of pattern 1, creating a continuous loop.

4 Make six folds along the slanted dotted lines, as shown.

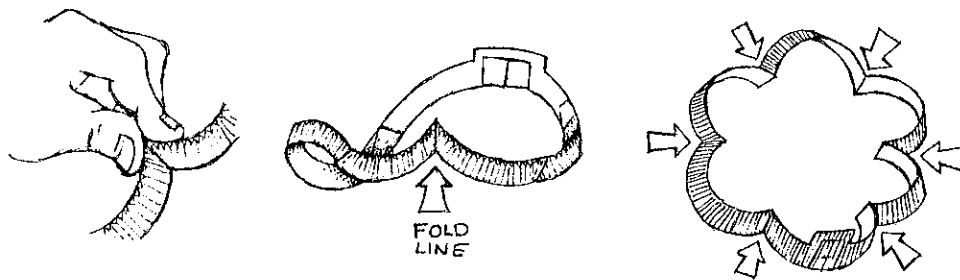

5 Cut the doors open on the fort gate. Then place the gate section facedown on the map, as shown. Match the folded corners to the black dots. Tape down the corners, as shown.

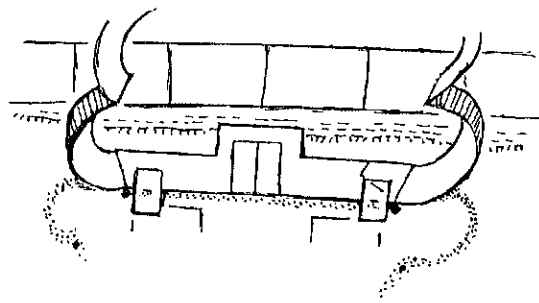

6 Continue taping down the folded corners to the black dots on the remaining two sections of the fort wall. Then turn up the fort walls so they stand straight.

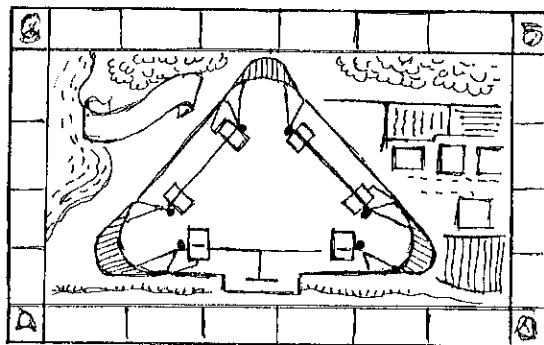

7 Cut out the 10 BUILDINGS. Fold and tape the sides of the CHURCH together, as shown. Tape the church, where indicated, inside the fort.

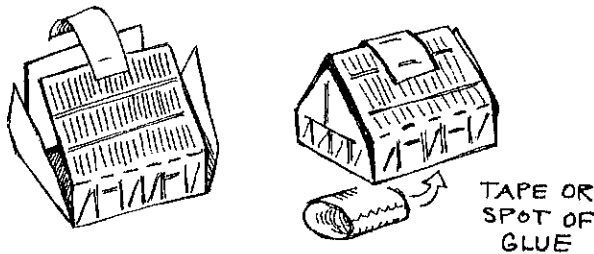

8 Fold and tape each HOUSE as shown. Tape three medium and three large houses inside the fort. Tape two medium and two large houses outside the fort.

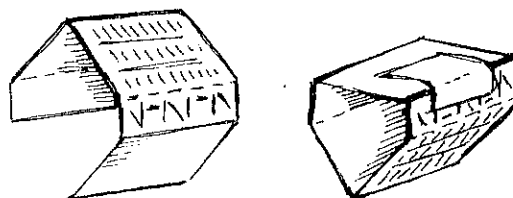

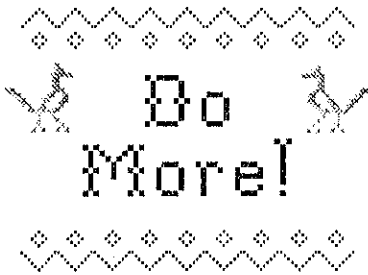

Challenge students to think and write about how they would have treated the Jamestown settlers if they belonged to one of Powhatan's tribes. Would they have helped the settlers? Would they have wanted the settlers to take over their land? Have them think of a plan that would have allowed the tribes and the English settlers to share the land and resources.

## Teaching With the Model

1 What was Jamestown? (*It was the first permanent English settlement in America.*)

2 Look at the people in the corners of the map—Captain John Smith, Chief Powhatan, Pocahontas, and John Rolfe. What do they have to do with Jamestown? (*Captain John Smith was a Jamestown leader, and he made the colonists work hard to survive. Chief Powhatan was the leader of the tribes that helped save Jamestown. According to legend, his daughter, Pocahontas, saved Captain Smith's life. She later married John Rolfe. Rolfe developed a tobacco that would grow in Jamestown. It became the colony's major cash crop.*)

3 Have students use the fort map coordinates to identify landmarks in the settlement and vice versa. Ask questions such as:

- ✦ What is located between C-2 and C-3? (*the church*)
- ✦ Where are the fields located? (*between F-3 and F-4, and between E-1 and F-1*)
- ✦ Where is the road located? (*between E-2 and F-2*)
- ✦ Where are the two boats located? (*B-4*)
- ✦ Where is the gate located? (*between C-3 and C-4*)
- ✦ What is located at A-3? (*cows drinking at trough*)

4 What happened to Fort James? (*No one knows. Some people think it was destroyed or was buried under mud during a flood.*)

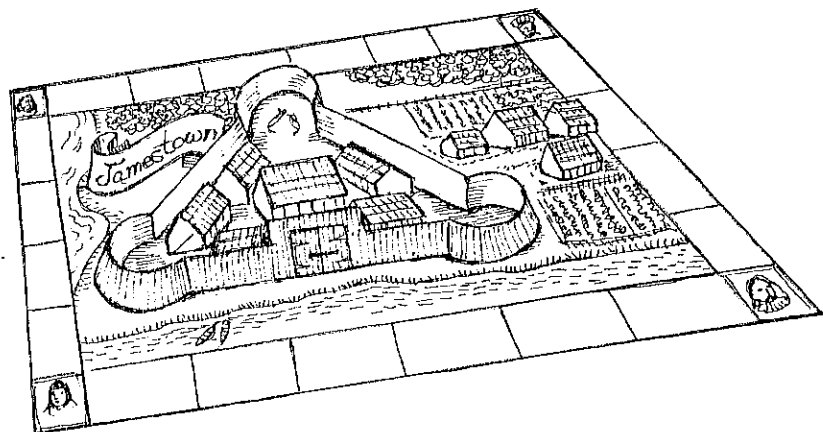

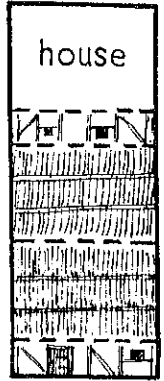
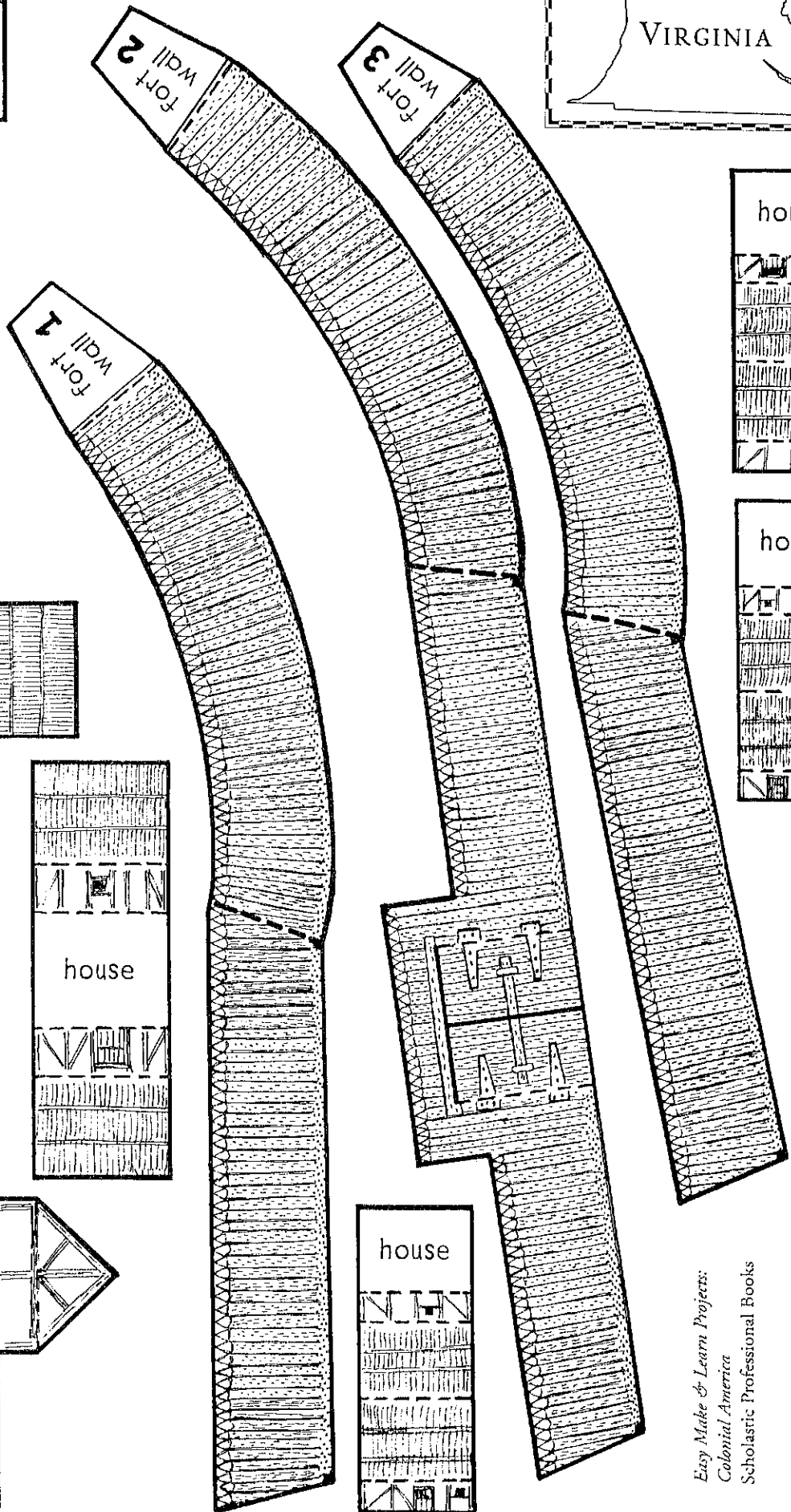
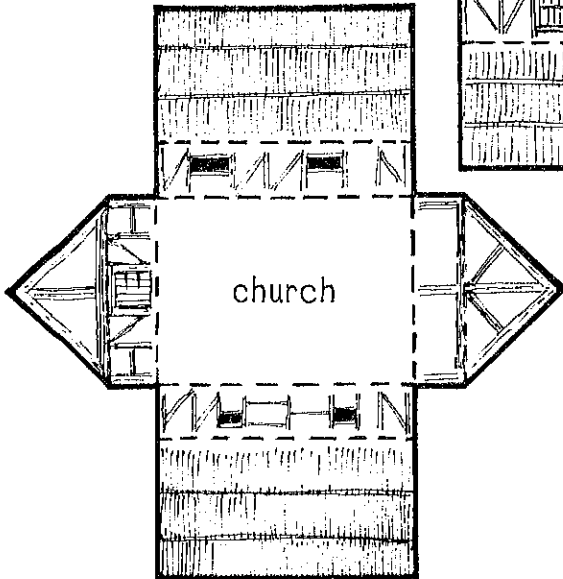
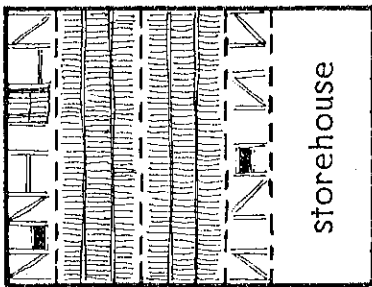
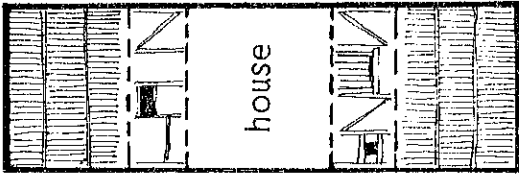
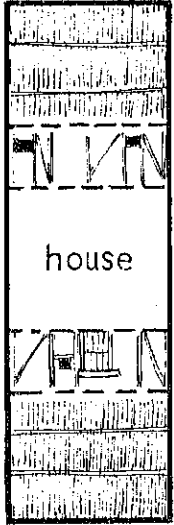
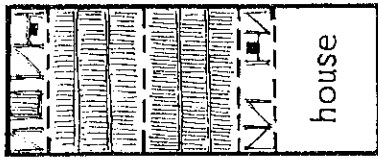

# 3-D Jamestown Map





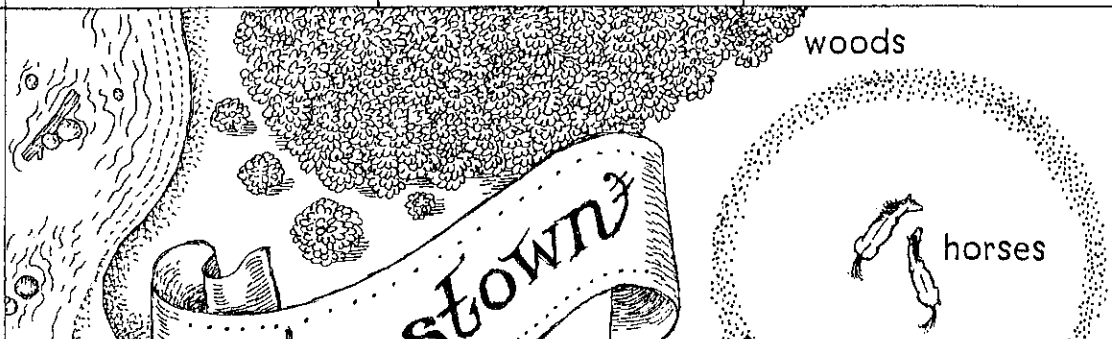
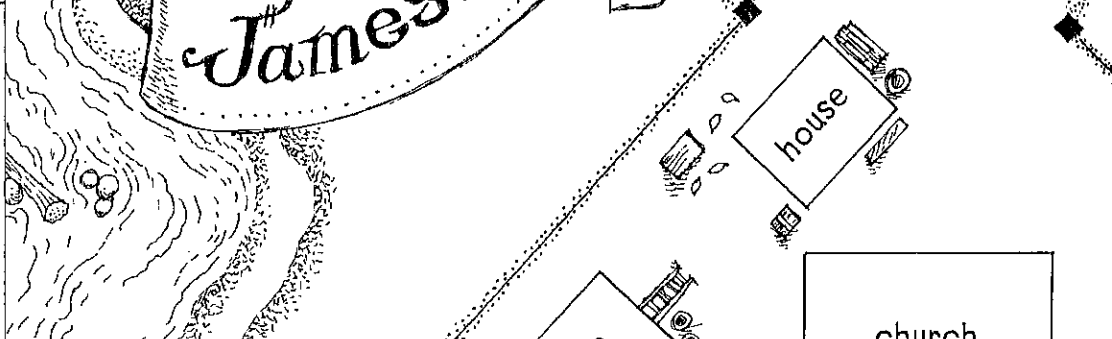
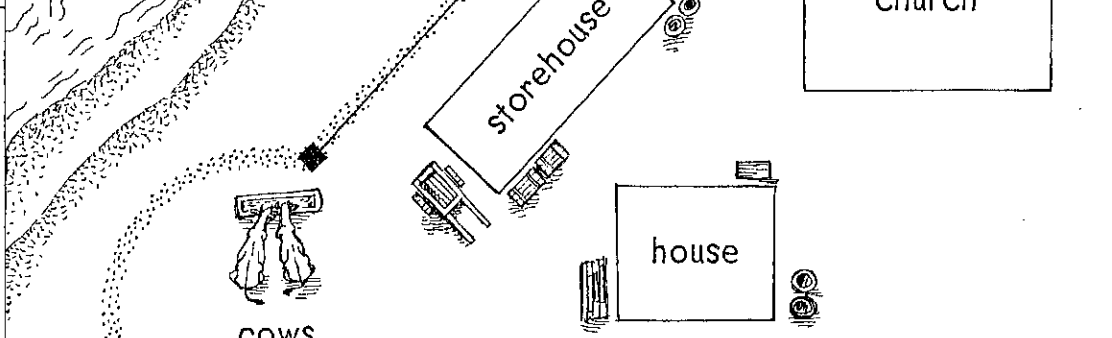
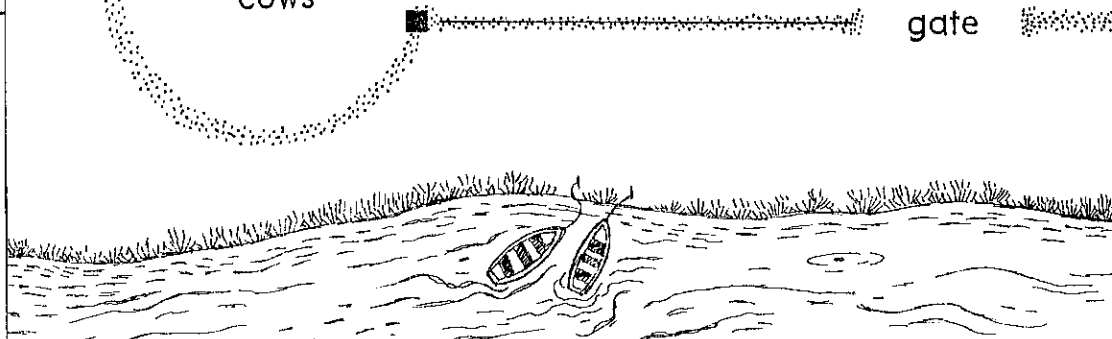







Easy Make & Learn Projects:  
Colonial America  
Scholastic Professional Books

# 3-D Jamestown Map

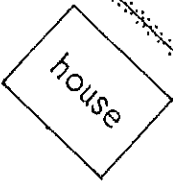
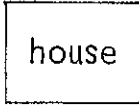
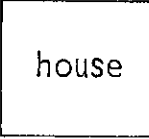
 Captain John Smith	A	B	C
1			
2			
3			
4			
 Pocahontas	A	B	C

Tape or glue the edge of page 21 here.

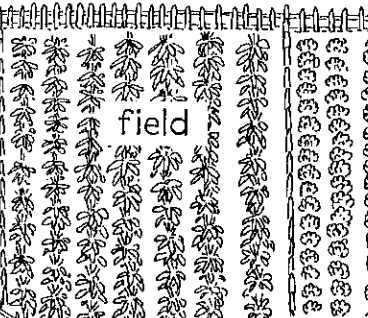
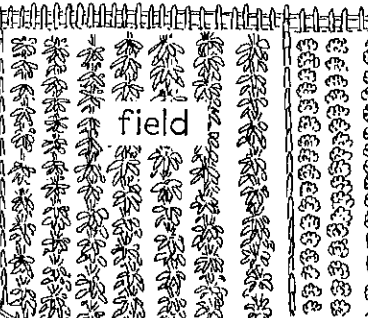
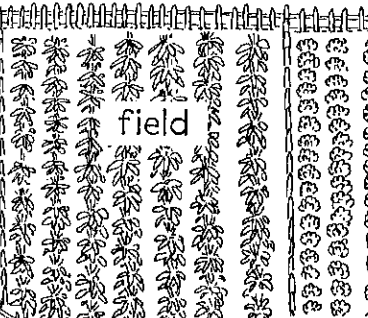
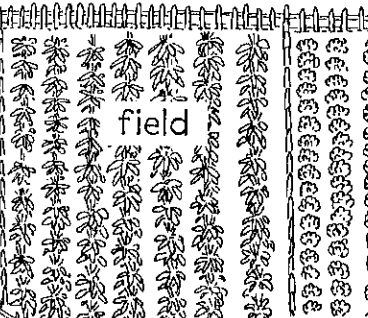
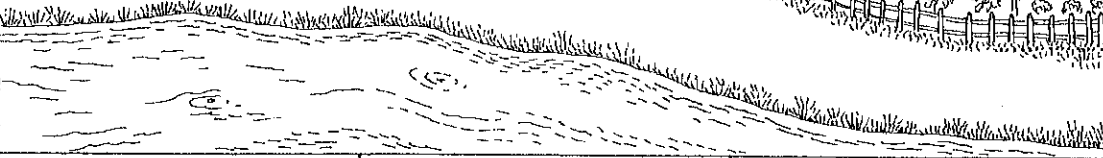
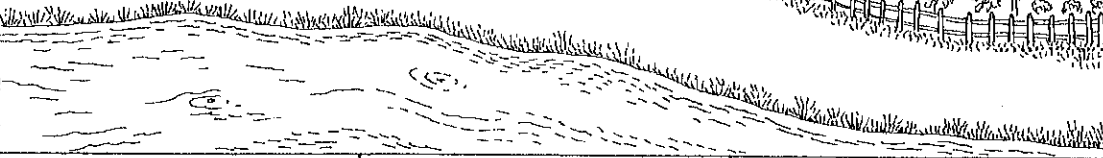
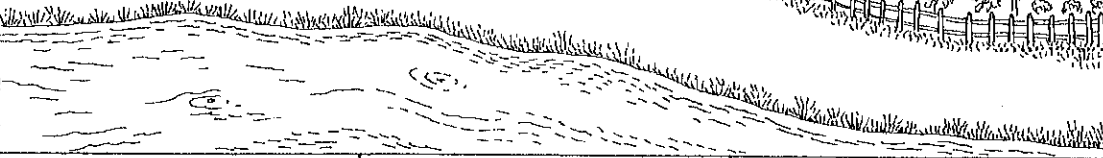
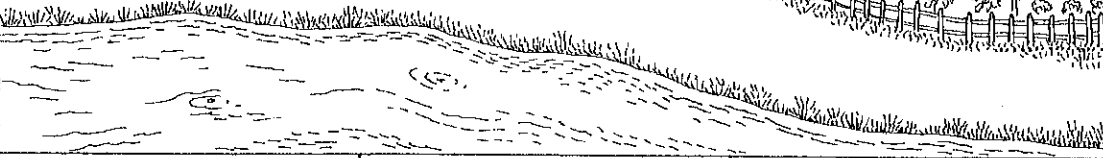
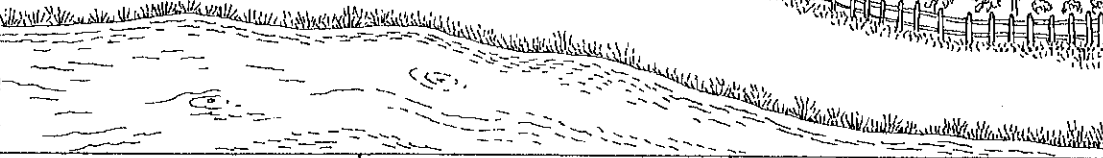
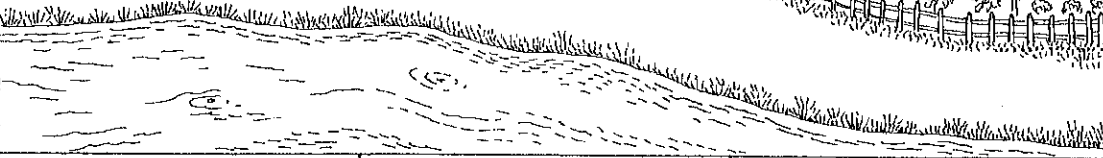
# 3-D Jamestown Map

D	E	F	 <p>Powhatan</p>
 <p>woods</p>			1
<p>Draw your own field.</p>	 <p>field</p>	 <p>field</p>	2
 <p>house</p>	 <p>house</p>	 <p>house</p>	3
 <p>house</p>	 <p>road</p>		4
 <p>house</p>	 <p>house</p>	 <p>field</p>	5
 <p>field</p>	 <p>field</p>	 <p>field</p>	6
			7
			8
D	E	F	 <p>John Rolfe</p>